

THIS PLAN IS FOR REFERENCE ONLY.
NO REPRESENTATION OR WARRANTY IS
MADE AS TO LOCATION OF BOUNDARIES
OR OTHER POINTS OF REFERENCE

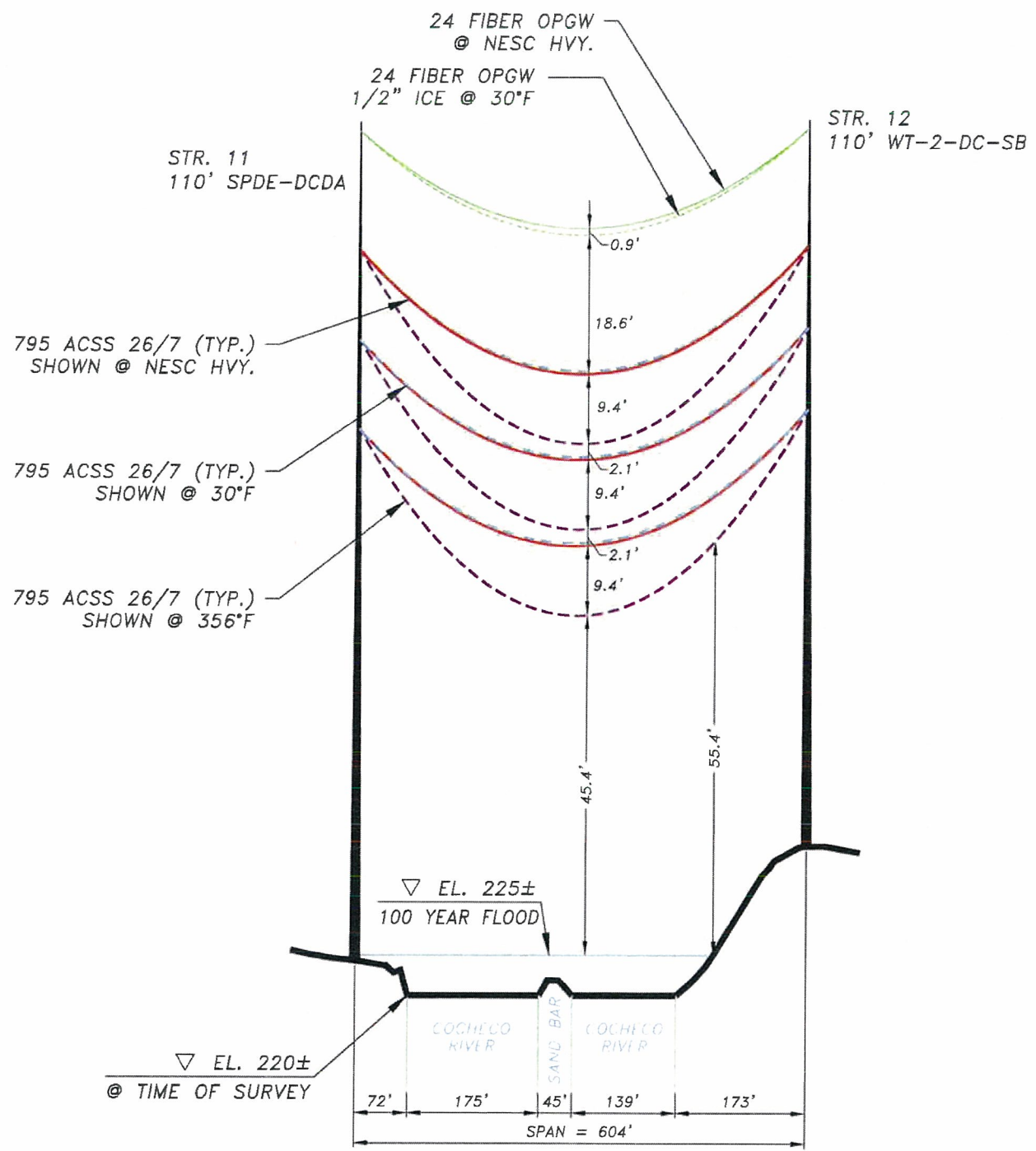

PROFILE

SCALE: 1"=200' HORIZ.
20' VERT.

24 FIBER OPGW INSTALLED @ 5300 LBS. NESC HVY. INITIAL
795 ACSS 26/7 INSTALLED @ 7000 LBS. NESC HVY. INITIAL

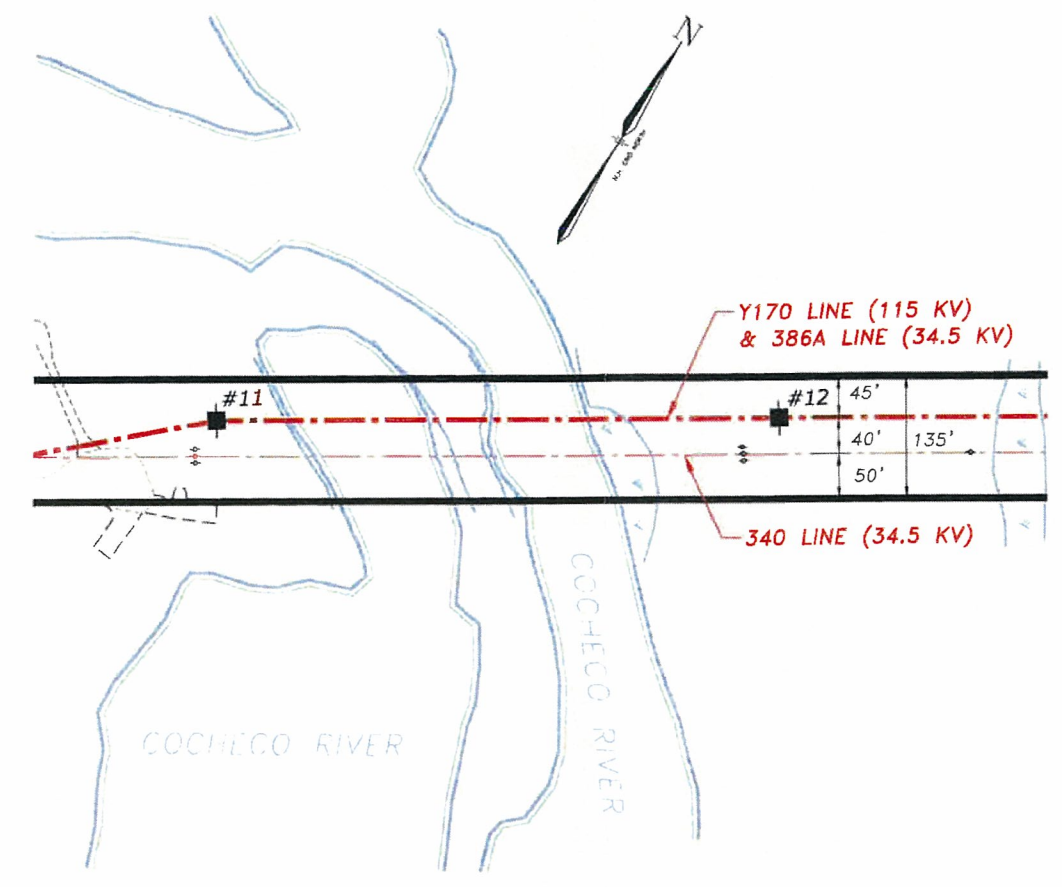

PLAN VIEW

SCALE: 1"=200'



GRAPHIC SCALE
(FEET)

EXHIBIT 3

| NO. | REVISION | DATE | DRWN | CHK | APPR |
|-----|--------------------------|----------|------|-----|------|
| 5 | RE-ISSUED FOR PERMITTING | 5/10/13 | SAT | NPA | |
| 4 | RE-ISSUED FOR PERMITTING | 11/28/12 | SAT | NPA | |
| 3 | RE-ISSUED FOR PERMITTING | 11/21/12 | SAT | NPA | |
| 2 | RE-ISSUED FOR PERMITTING | 10/4/12 | SAT | NPA | |
| 1 | RE-ISSUED FOR PERMITTING | 10/2/12 | SAT | NPA | |
| 0 | ISSUED FOR PERMITTING | 9/27/12 | SAT | NPA | |

| | | | | |
|---|--|-------------------------|-------------------------|------------------------------------|
| <p>Public Service of New Hampshire</p> | Transmission Business | | | |
| | <p>Y170 LINE (115 KV) BETWEEN STRUCTURES 11 AND 12 COCHECO RIVER WATER CROSSING ROCHESTER, NEW HAMPSHIRE</p> | | | |
| <p>DRAWN SAT</p> <p>DESIGNED PEC</p> <p>CHECKED NPA</p> <p>APPROVED</p> | <p>SCALE AS NOTED</p> | <p>DATE 8/20/12</p> | <p>SHEET 1 OF 1</p> | <p>DRAWING NO. D-10237-600</p> |

THIS PLAN IS FOR REFERENCE ONLY.
NO REPRESENTATION OR WARRANTY IS
MADE AS TO LOCATION OF BOUNDARIES
OR OTHER POINTS OF REFERENCE

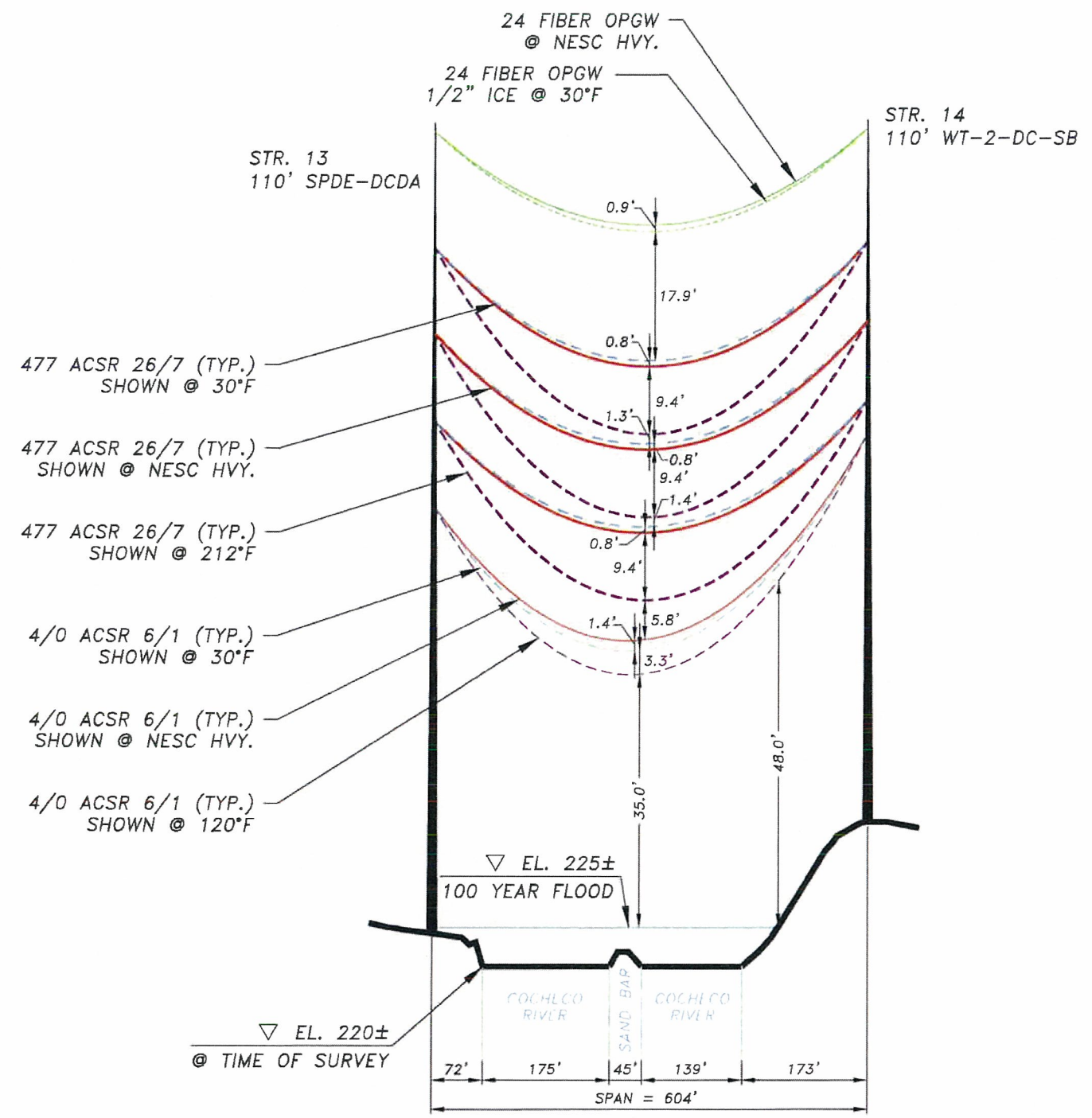

PROFILE

SCALE: 1"=200' HORIZ.
20' VERT.

24 FIBER OPGW INSTALLED @ 5300 LBS. NESC HVY. INITIAL
477 ACSR 26/7 INSTALLED @ 5000 LBS. NESC HVY. INITIAL
4/0 ACSR 6/1 INSTALLED @ 2500 LBS. NESC HVY. INITIAL

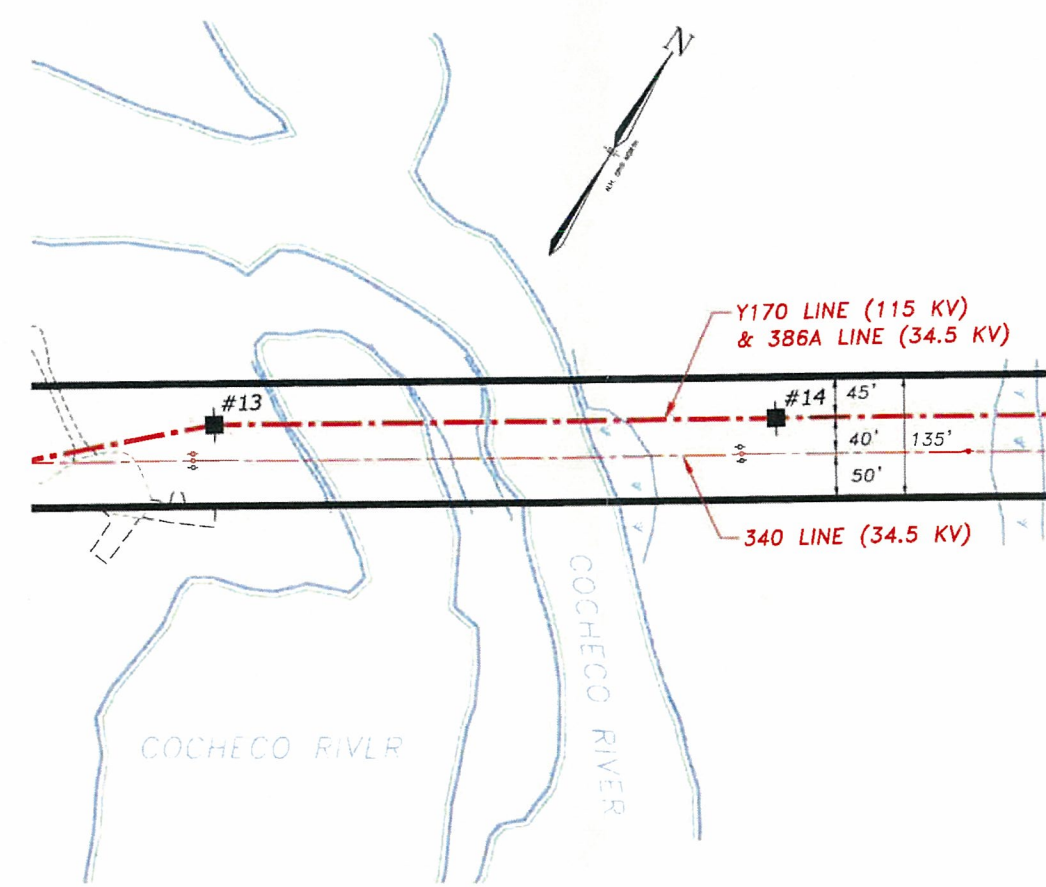

PLAN VIEW

SCALE: 1"=200'



GRAPHIC SCALE
1" = 200'

EXHIBIT 4

| NO. | REVISION | DATE | DRWN | CHK | APPR |
|-----|--------------------------|----------|------|-----|------|
| 3 | RE-ISSUED FOR PERMITTING | 5/10/13 | SAT | NPA | |
| 2 | RE-ISSUED FOR PERMITTING | 11/21/12 | SAT | NPA | |
| 1 | RE-ISSUED FOR PERMITTING | 10/2/12 | SAT | NPA | |
| 0 | ISSUED FOR PERMITTING | 9/27/12 | SAT | NPA | |

| | | | | |
|--|--|-----------------|-----------------|--------------------------|
| Public Service of New Hampshire | | Energy Delivery | | |
| DRAWN SAT | 386A LINE (34.5 KV) BETWEEN STRUCTURES 13 AND 14 COCHECO RIVER WATER CROSSING ROCHESTER, NEW HAMPSHIRE | | | |
| DESIGNED PEC | | | | |
| CHECKED NPA | | | | |
| APPROVED | SCALE AS NOTED | DATE 8/20/12 | SHEET 1 OF 1 | DRAWING NO D-7649-410 |